

DRC

PZ22- 12000032
11/05/2025

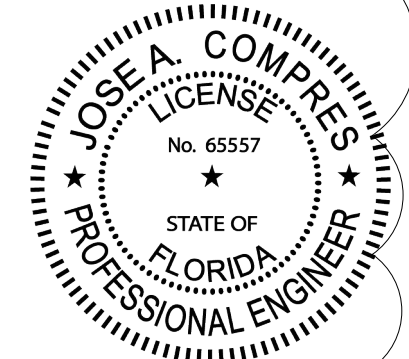
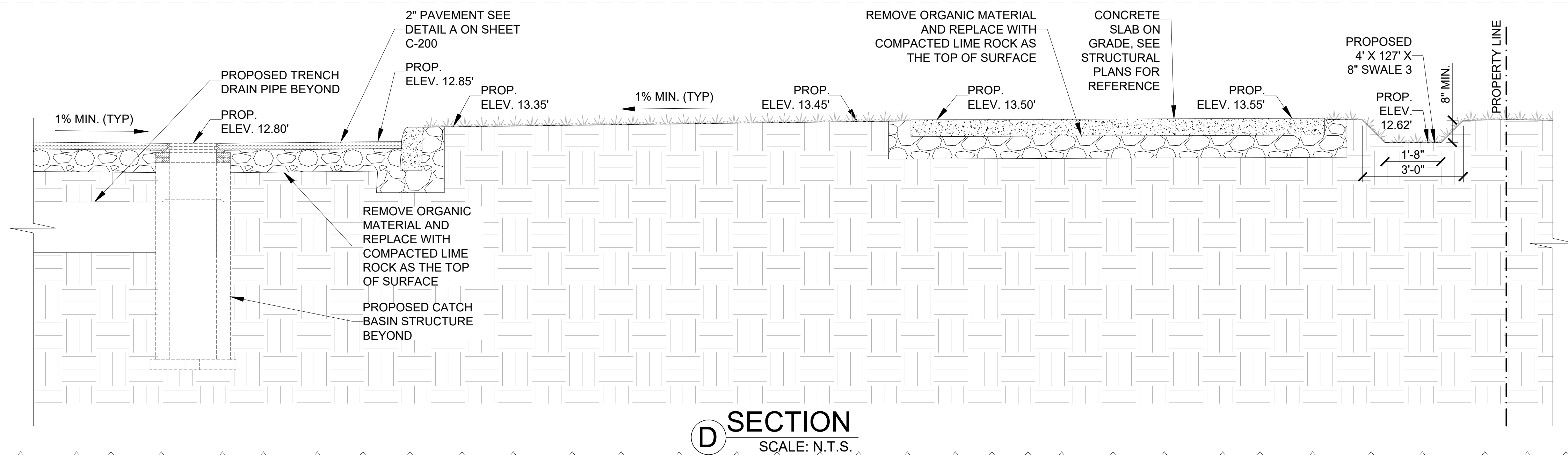
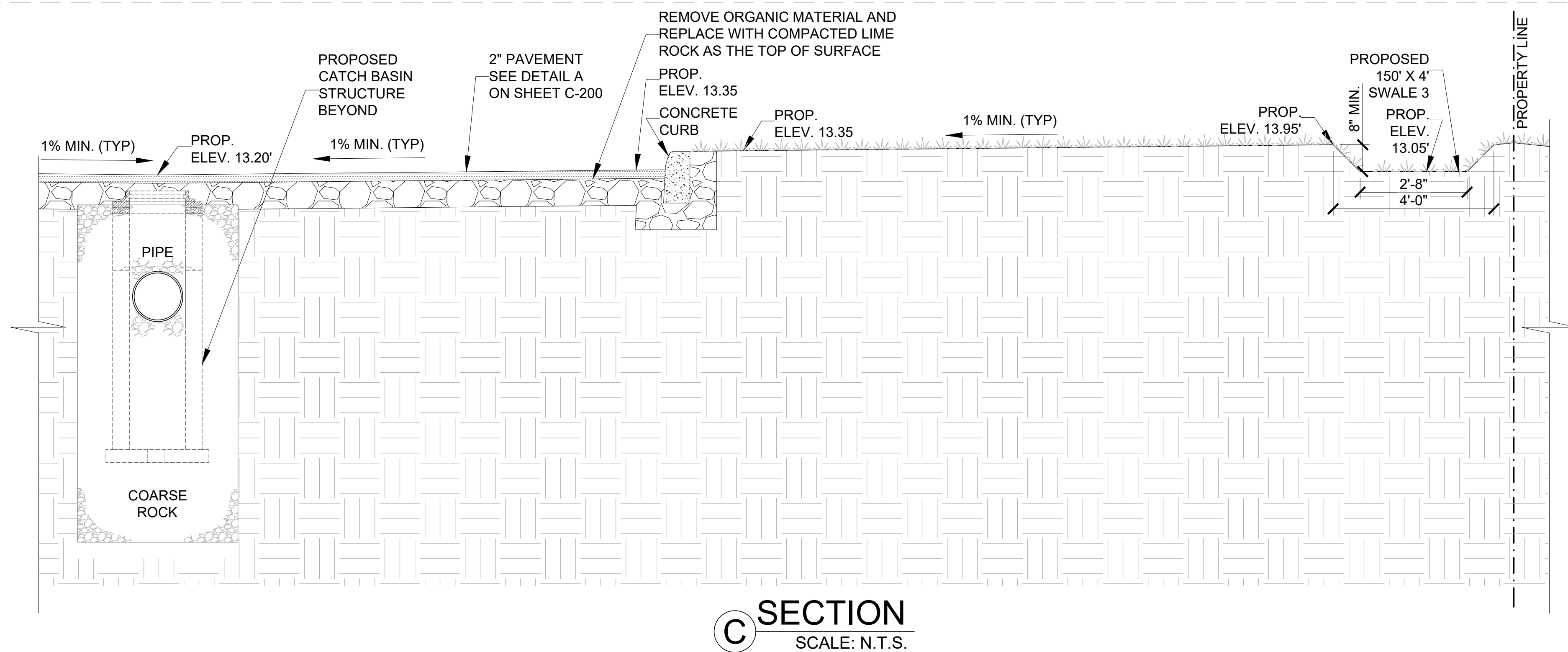
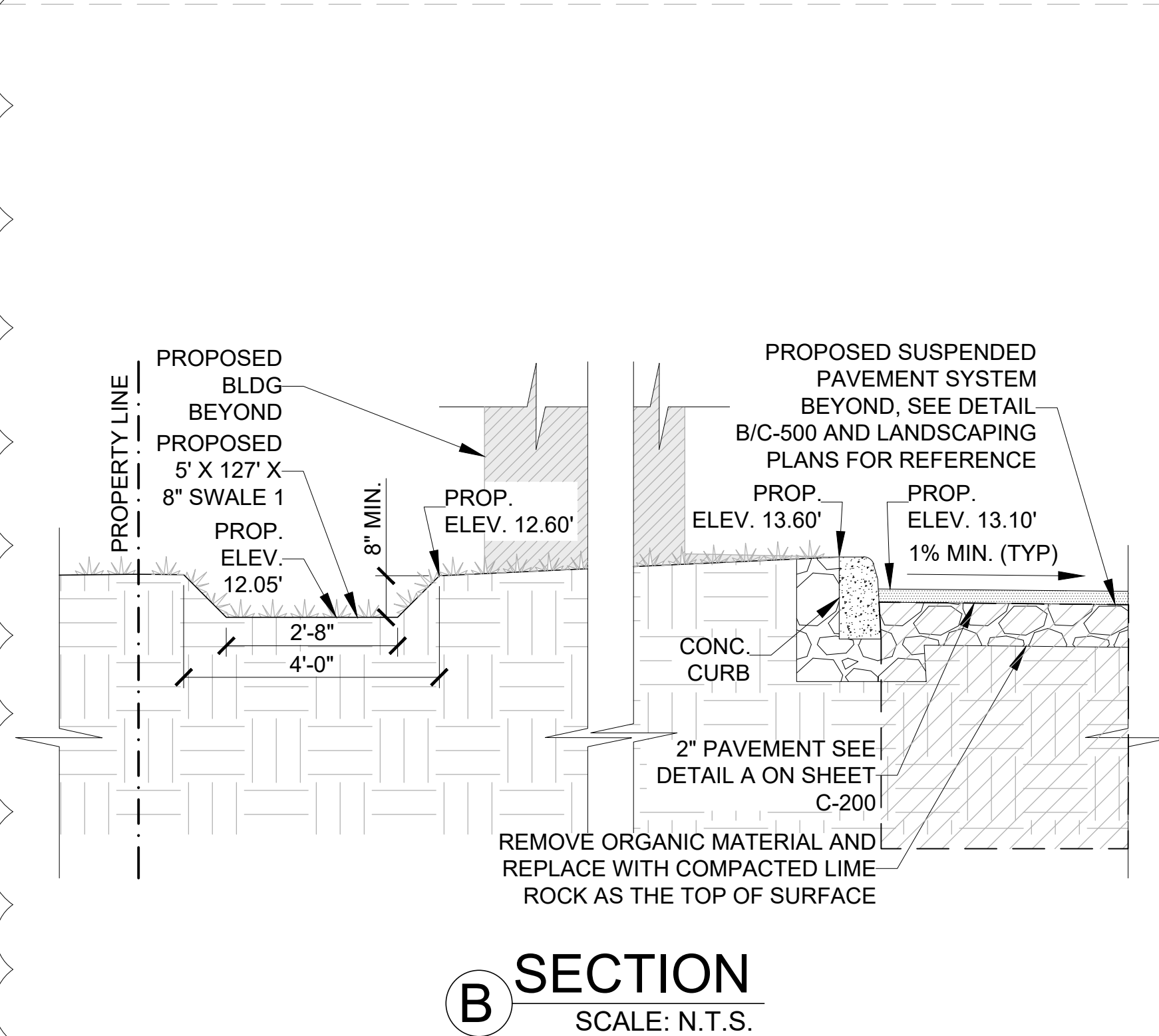
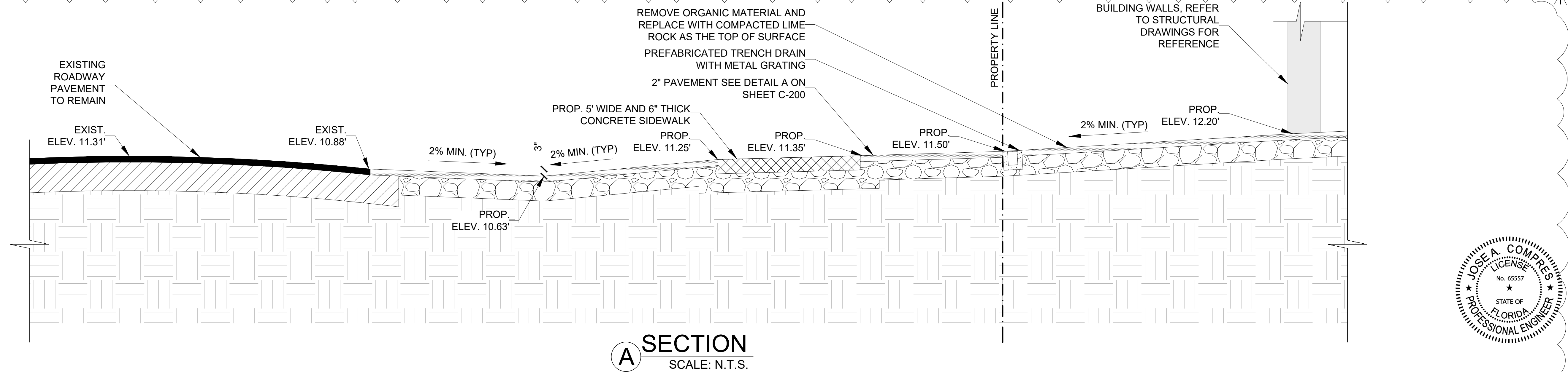

CONEMCO
ENGINEERING, INC.
DBA Conemco Consultants
SBA 8a - Civil - Structural - MEP - CEI - Program Management - Land Surveyors

782 NW 42ND AVENUE UNIT 635
MIAMI, FL 33126
MAIN NUMBER 888-636-1536
CA # 29447

THIS DRAWING HAS BEEN ELECTRONICALLY SIGNED AND SEALED BY JOSE A. COMPRES ON THE DATE INDICATED IN THE SIGNATURE. PRINTED COPIES OF THIS DOCUMENT ARE NOT CONSIDERED SIGNED AND SEALED AND THE SIGNATURE MUST BE VERIFIED ON ANY ELECTRONIC COPIES.

JOSE A. COMPRES, P.E.
FLORIDA P.E. LIC. # 65557
CONEMCO ENGINEERING, INC.

PROJECT NAME / ADDRESS:
324 HAUS MIXED USE / NEW BUILDING - CIVIL PLANS REDESIGN
324 NW 6TH STREET, POMPA NO BEACH, FL 33060

CLIENT/TOWNER:
AUSTIN FOX ARCHITECTURE
1754 E COMMERCIAL BLVD, FORT LAUDERDALE, FL 33334

REVISIONS	DATE
1 CITY COMM.	09-08-2025

DATE:	9/12/2025
SCALE:	AS SHOWN
DRAWN:	FP
CHECKED:	PS
APPVD:	JC
PROJECT ID:	FPV-C251004
CONTRACT NO:	-

SHEET NAME:
SECTIONS

DRAWING NO.
C-503
Sheet No.
13 OF 18